

A FLECK PERFORMANCE BULLETIN

Product Application Service General news from Fleck Controls

October 12, 1995

5600 Powerhead & 3200 Timer Modifications

We will be making an improvement to the 5600 powerhead and the 3200 timer. This change will eliminate the need for the P/N 13299 curved washer between the motor mounting plate and the drive gear. This change was made by modifications to the motor mounting plate and idler gear. The motor mounting plate now will have a recessed pocket stamped on it, and the idler gear is 0.030" shorter. The drawings on the following page indicate these modifications.

When servicing an old powerhead timer to the new style it will be necessary to change both the motor mounting plate and idler gear. The new parts needed to convert from the old style to the new style can be ordered by using P/N 60369-02 for a 5600 powerhead and P/N 60369-01 for the 3200 timer.

As always, thank you for using Fleck Controls.

Sincerely,

Fleck Controls Inc
Technical Product Support

5600 Powerhead

OLD STYLE

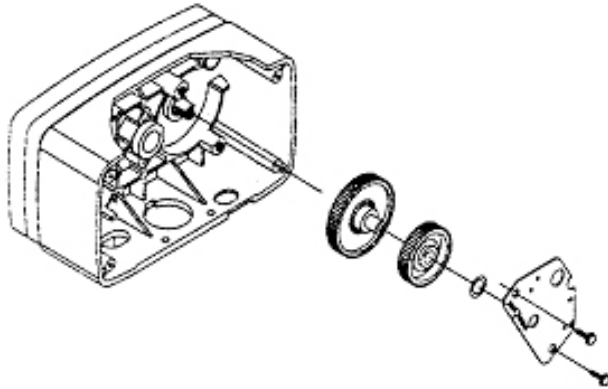

NEW STYLE

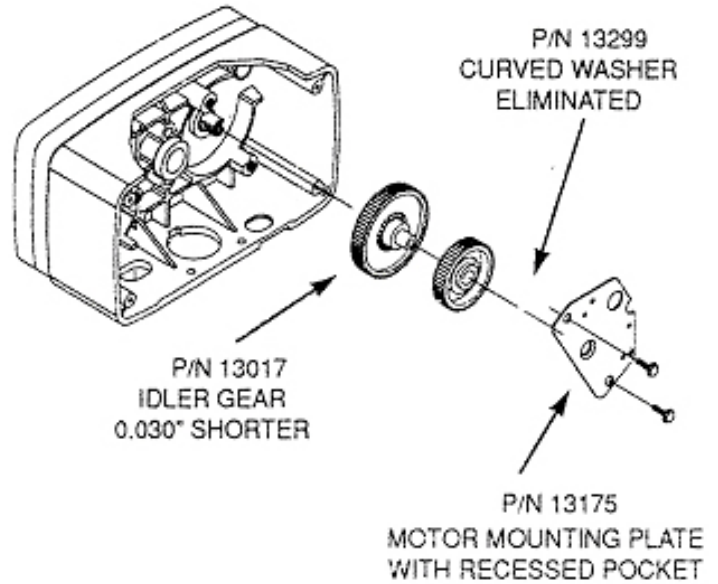

Note: P/N 60369-02 contains the necessary items to convert a 5600 powerhead from old style to new style.

3200 Timer

OLD STYLE

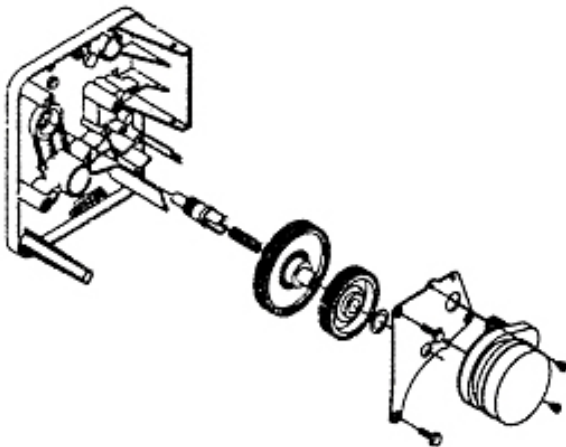

NEW STYLE

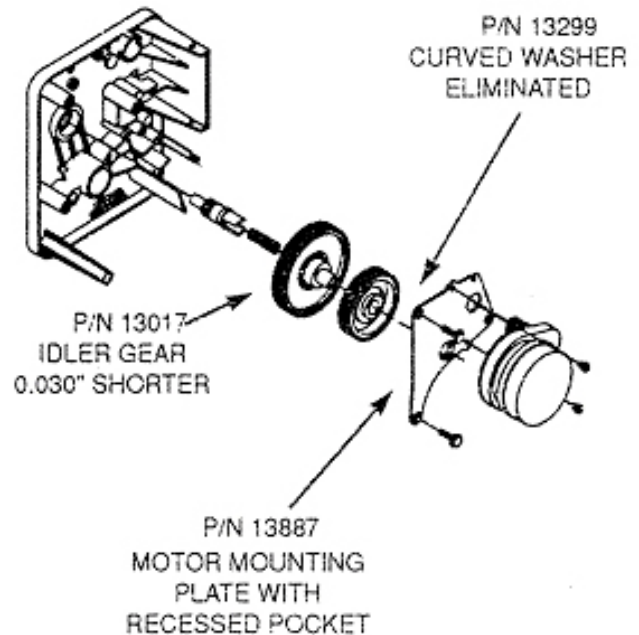

Note: P/N 60369-01 contains the necessary items to convert a 3200 timer from old style to new style.